

FAY GARDENS

A DEVELOPMENT BY TARAF X MASDAR CITY

FAY
— HILLS —

An aerial photograph of a resort pool deck. The pool is kidney-shaped with a light-colored sand beach area. The deck is made of wood and features several lounge chairs and white umbrellas. A curved metal railing runs along the edge of the deck. In the foreground, there is a lush garden with various plants, including purple flowers and tall grasses. A concrete path leads through the garden. The scene is set during the golden hour, with warm lighting and long shadows.

From Shaded
WALKING TRAILS

To Plazas,
GARDENS

And Gathering,
SPACES

Fay Hills
IS BUILT

For Interaction

An aerial architectural rendering of a modern residential development. The scene is dominated by a central green park area featuring a winding path, a swimming pool, and a landscaped garden with various trees and plants. Surrounding the park are several multi-story residential buildings with a contemporary, minimalist design. The buildings have flat roofs and large windows. The overall atmosphere is one of a well-planned, green urban environment.

The Vision
A CITY IN BALANCE



Abu Dhabi
International Airport

FAY

— HILLS —

Masdar City

Khalifa City

7 mins

Abu Dhabi
International Airport

9 mins

Khalifa
City

16 mins

Yas
Island

18 mins

Zayed
University

Abu Dhabi's
NEW GREEN HEART





Design That Breathes.
SPACES THAT LIVE.



Introducing
FAY GARDENS



Born of earth,
AIR, AND WATER

Breathe.
BELONG. BEGIN.





130

Sustainable Villas

33

Acres Site

3

Villa Typologies

Terra
PARK

Aria
PARK

Azura
PARK

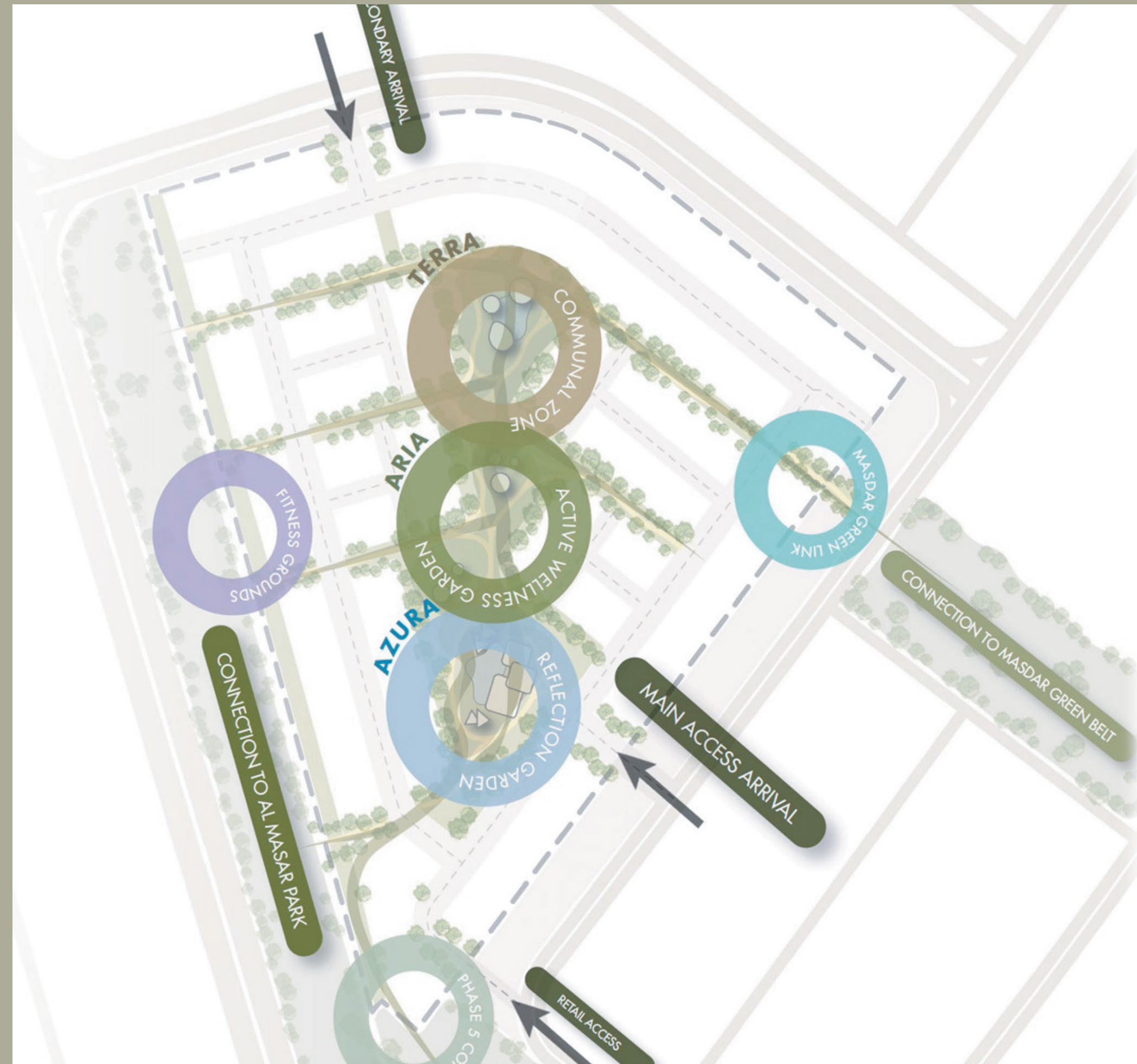



TERRA PARK
Grounded in Earth's Layer



ARIA PARK
Winds of Rejuvenation



A place where Wellness and Lifestyle
BLEND SEAMLESSLY



AZURA PARK
Reflections of Serenity



Community
CLUBHOUSE



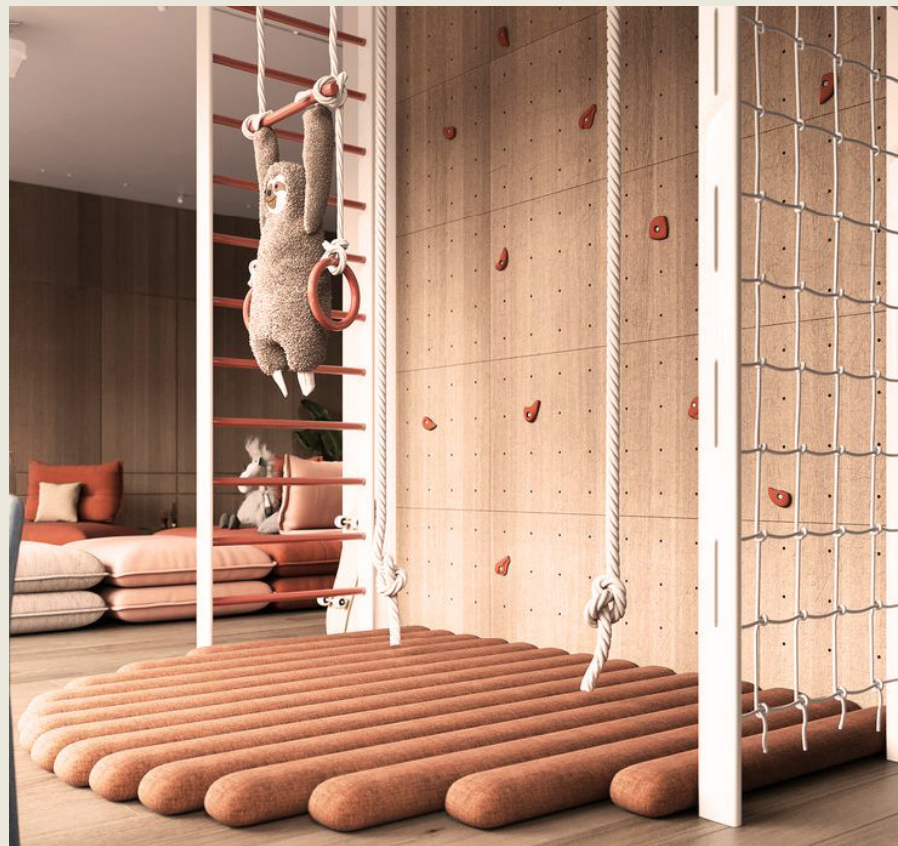



THE VILLAS
Private Sanctuaries of Life

FAY
— HILLS —

4 BEDROOM VILLA
Type 1



4 BEDROOM VILLA
Type 1



5 BEDROOM VILLA
Type 1



5 BEDROOM VILLA
Type 1



6 BEDROOM VILLA
TYPE 1



6 BEDROOM VILLA
TYPE 1





INTERIORS
Crafted for Stillness

Soft colors, warm textures and natural materials invite comfort and calm.

Wood and natural
FINISHES





FLOOR-TO-CEILING
openings to nature



SMART
family-friendly planning



KITCHEN



MASTER BATHROOM



TARAF

X

MASDAR
CITY 