

# WADI HILLS

HRE  
DEVELOPMENT



## FLOOR PLANS

Disclaimer: All floor plans, layouts, dimensions, and specifications shown are for illustrative purposes only and are subject to change at the discretion of HRE Development without prior notice. The developer reserves the right to make modifications during the design and construction phases as necessary.

# 1ST FLOOR

Disclaimer: All floor plans, layouts, dimensions, and specifications shown are for illustrative purposes only and are subject to change at the discretion of HRE Development without prior notice. The developer reserves the right to make modifications during the design and construction phases as necessary.

1-BED

Apartment 01

Level  
1st Floor

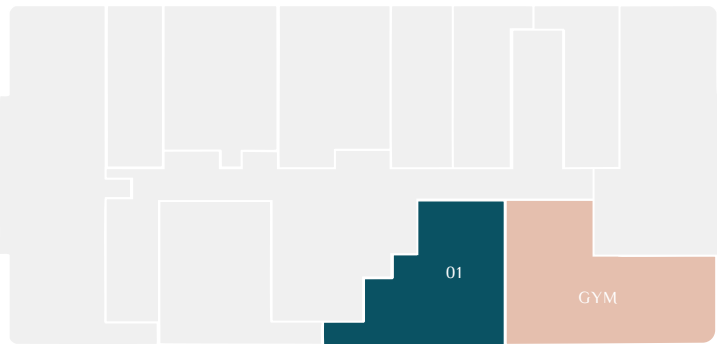

|              |            |
|--------------|------------|
| Suite :      | 562.4 sqft |
| Balcony :    | 169.9 sqft |
| Total Area : | 732.3 sqft |

Disclaimer: All floor plans, layouts, dimensions, and specifications shown are for illustrative purposes only and are subject to change at the discretion of HRE Development without prior notice. The developer reserves the right to make modifications during the design and construction phases as necessary.





Studio

Apartment 03

Level  
1st Floor

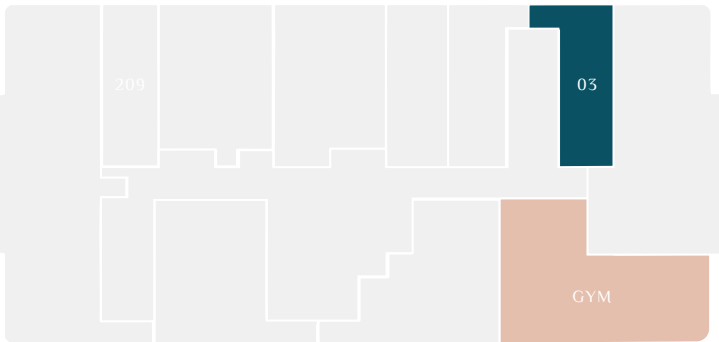

Suite : 322.5 sqft

Balcony : 77.9 sqft

Total Area : 400.4 sqft

Disclaimer: All floor plans, layouts, dimensions, and specifications shown are for illustrative purposes only and are subject to change at the discretion of HRE Development without prior notice. The developer reserves the right to make modifications during the design and construction phases as necessary.



Studio

Apartment 04

Level

1st Floor

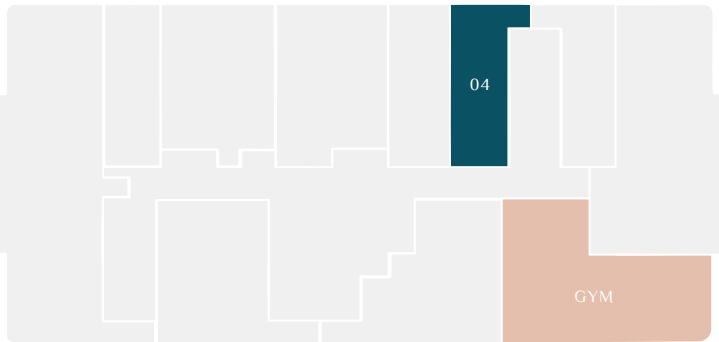

Suite : 341.5 sqft

Balcony : 77 sqft

Total Area : 418.5 sqft

Disclaimer: All floor plans, layouts, dimensions, and specifications shown are for illustrative purposes only and are subject to change at the discretion of HRE Development without prior notice. The developer reserves the right to make modifications during the design and construction phases as necessary.





Studio

Apartment 05

Level

1st Floor

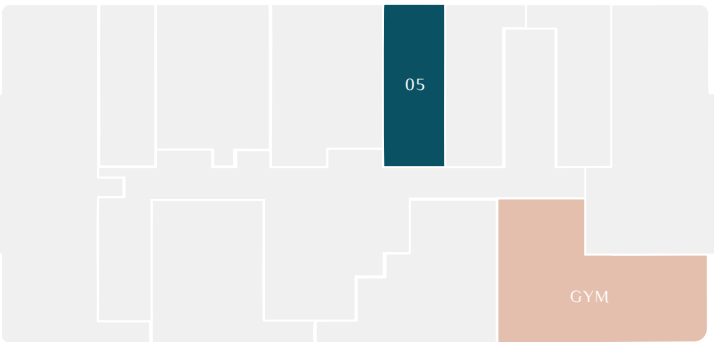

Suite : 335.7 sqft

Balcony : 55 sqft

Total Area : 390.7 sqft

Disclaimer: All floor plans, layouts, dimensions, and specifications shown are for illustrative purposes only and are subject to change at the discretion of HRE Development without prior notice. The developer reserves the right to make modifications during the design and construction phases as necessary.





1-BED

Apartment 06

Level  
1st Floor

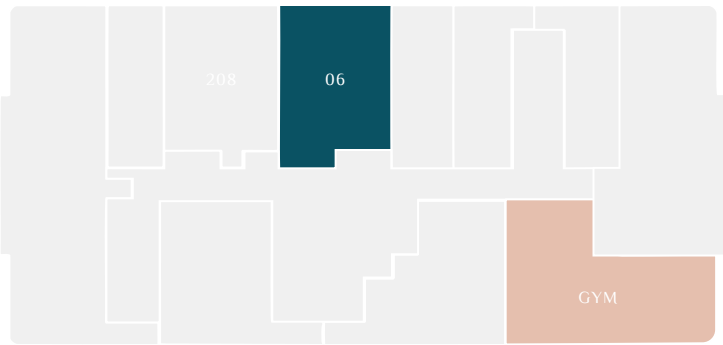

Suite : 602.1 sqft  
Balcony : 104.3 sqft  
Total Area : 706.4 sqft

Disclaimer: All floor plans, layouts, dimensions, and specifications shown are for illustrative purposes only and are subject to change at the discretion of HRE Development without prior notice. The developer reserves the right to make modifications during the design and construction phases as necessary.





1-BED

Apartment 07

Level  
1st Floor

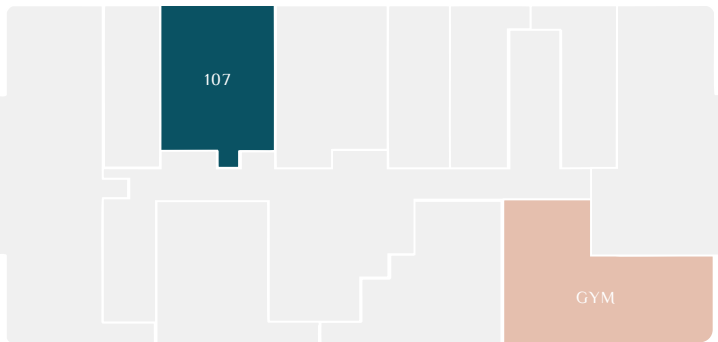

|              |            |
|--------------|------------|
| Suite :      | 577.9 sqft |
| Balcony :    | 104.2 sqft |
| Total Area : | 682.1 sqft |

Disclaimer: All floor plans, layouts, dimensions, and specifications shown are for illustrative purposes only and are subject to change at the discretion of HRE Development without prior notice. The developer reserves the right to make modifications during the design and construction phases as necessary.

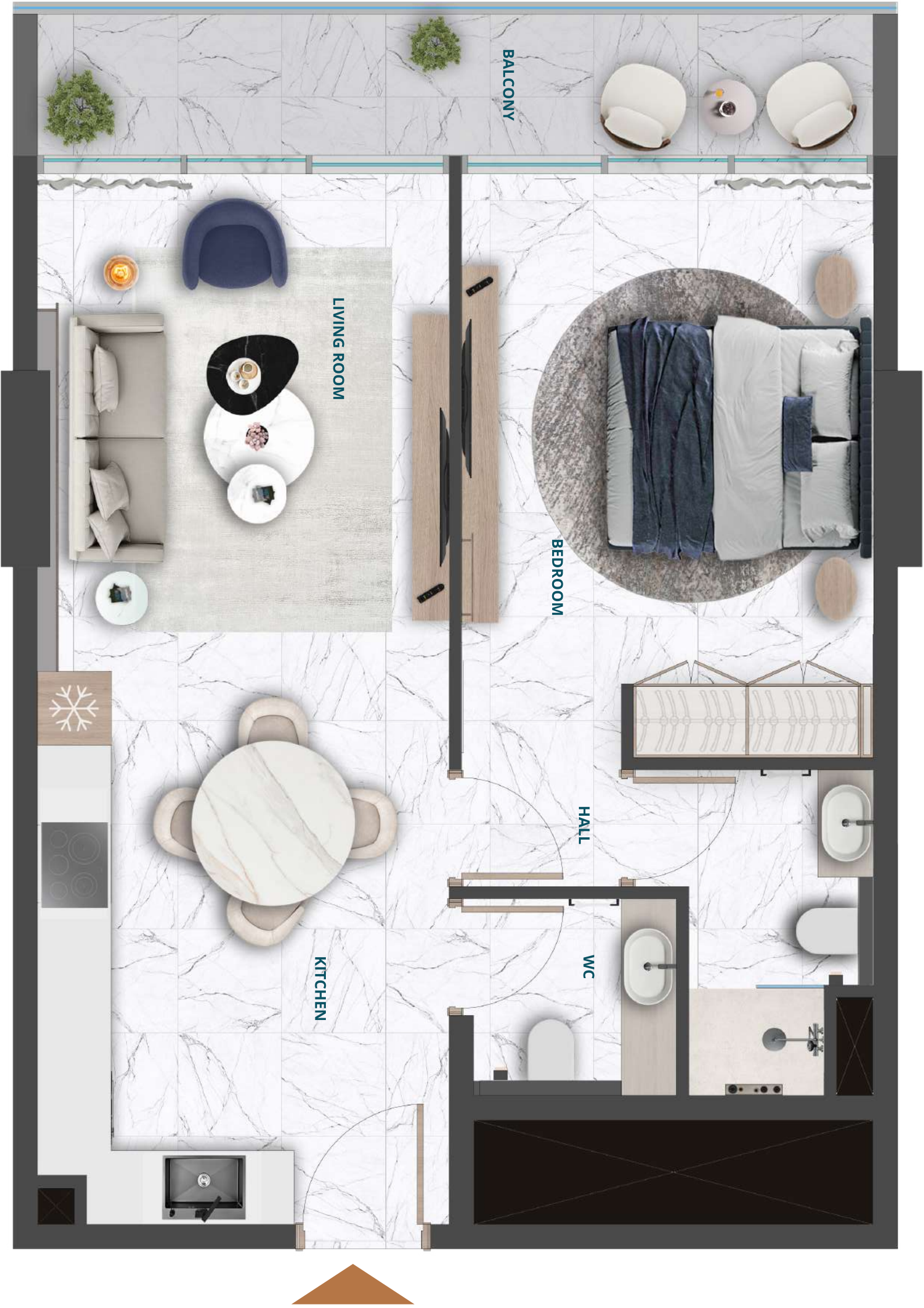



Studio

Apartment 08

Level

1st Floor

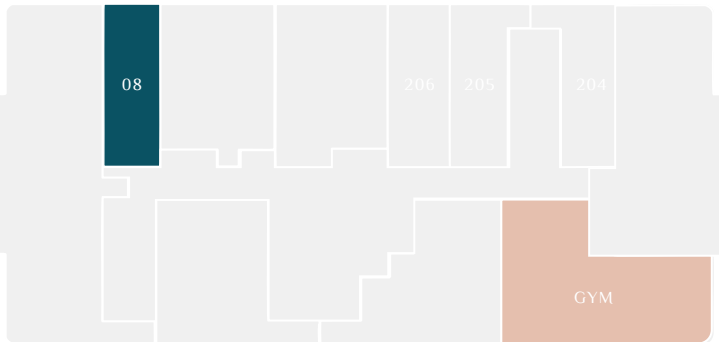

Suite : 316.8 sqft

Balcony : 52.1 sqft

Total Area : 368.9 sqft

Disclaimer: All floor plans, layouts, dimensions, and specifications shown are for illustrative purposes only and are subject to change at the discretion of HRE Development without prior notice. The developer reserves the right to make modifications during the design and construction phases as necessary.



3-BED

Apartment 09

Level

1st Floor

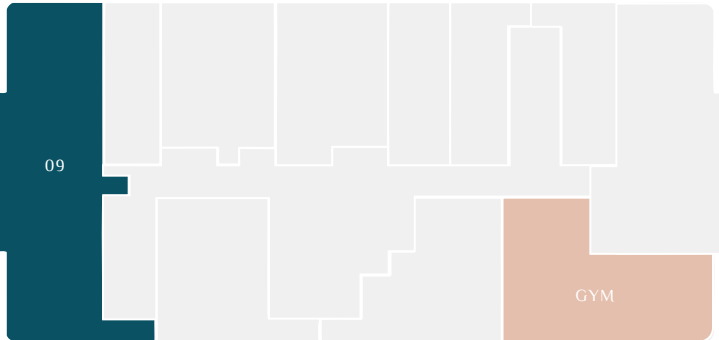

Suite

:

1062.1 sqft

Balcony

:

423.3 sqft

Total Area

:

1,485.4 sqft

Disclaimer: All floor plans, layouts, dimensions, and specifications shown are for illustrative purposes only and are subject to change at the discretion of HRE Development without prior notice. The developer reserves the right to make modifications during the design and construction phases as necessary.





1-BED

Apartment 10

Level  
1st Floor

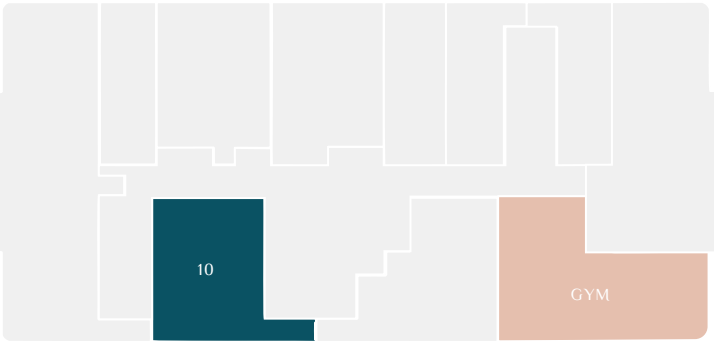

Suite : 567.6 sqft

Balcony : 154.5 sqft

Total Area : 722.1 sqft

Disclaimer: All floor plans, layouts, dimensions, and specifications shown are for illustrative purposes only and are subject to change at the discretion of HRE Development without prior notice. The developer reserves the right to make modifications during the design and construction phases as necessary.



# TYPICAL FLOOR

Disclaimer: All floor plans, layouts, dimensions, and specifications shown are for illustrative purposes only and are subject to change at the discretion of HRE Development without prior notice. The developer reserves the right to make modifications during the design and construction phases as necessary.



1-BED

Apartment 01

Level  
Typical Floor (2+)

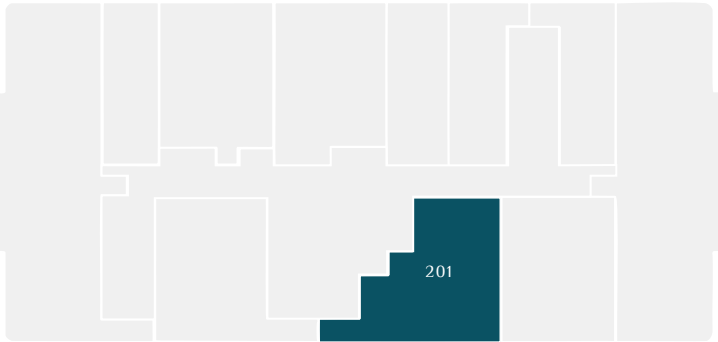

- Suite : 562.4 sqft
- Balcony : 172 sqft
- Total Area :734.4 sqft

Disclaimer: All floor plans, layouts, dimensions, and specifications shown are for illustrative purposes only and are subject to change at the discretion of HRE Development without prior notice. The developer reserves the right to make modifications during the design and construction phases as necessary.





# 1-BED

# Apartment 02

Level

## Typical Floor (2+)



|              |            |
|--------------|------------|
| Suite :      | 566.6 sqft |
| Balcony :    | 105 sqft   |
| Total Area : | 672 sqft   |

Disclaimer: All floor plans, layouts, dimensions, and specifications shown are for illustrative purposes only and are subject to change at the discretion of HRE Development without prior notice. The developer reserves the right to make modifications during the design and construction phases as necessary.





3-BED

Apartment 03

Level

Typical Floor (2+)

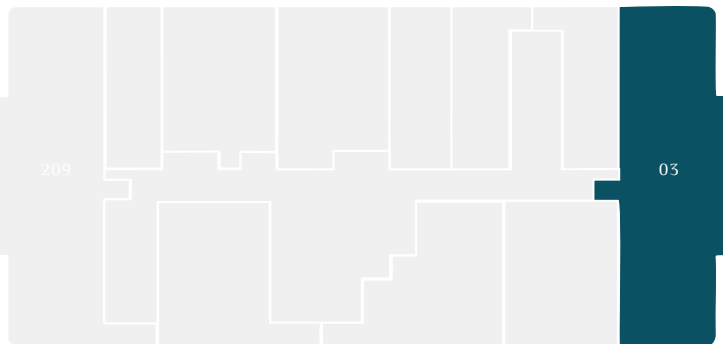

Suite : 1060 sqft

Balcony : 376.8 sqft

Total Area : 1,436.5 sqft

Disclaimer: All floor plans, layouts, dimensions, and specifications shown are for illustrative purposes only and are subject to change at the discretion of HRE Development without prior notice. The developer reserves the right to make modifications during the design and construction phases as necessary.



Studio

Apartment 04

Level  
Typical Floor (2+)

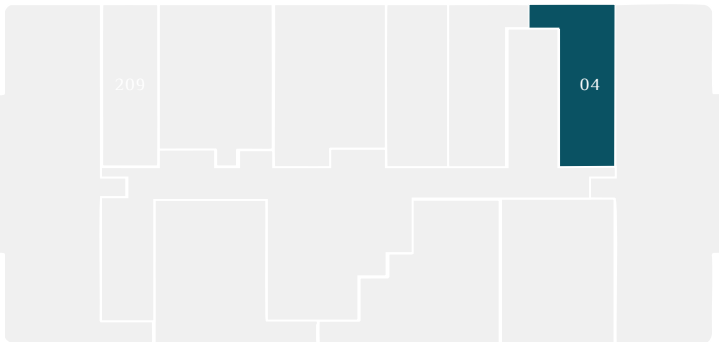

|              |            |
|--------------|------------|
| Suite :      | 322.5 sqft |
| Balcony :    | 79 sqft    |
| Total Area : | 401.5 sqft |

Disclaimer: All floor plans, layouts, dimensions, and specifications shown are for illustrative purposes only and are subject to change at the discretion of HRE Development without prior notice. The developer reserves the right to make modifications during the design and construction phases as necessary.





Studio

Apartment 05

Level

Typical Floor (2+)

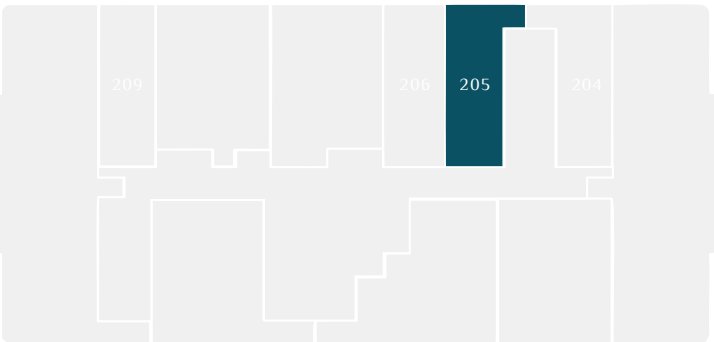

|            |             |
|------------|-------------|
| Suite :    | 341.5 sqft  |
| Balcony :  | 78.4 sqft   |
| Total Area | :419.9 sqft |

Disclaimer: All floor plans, layouts, dimensions, and specifications shown are for illustrative purposes only and are subject to change at the discretion of HRE Development without prior notice. The developer reserves the right to make modifications during the design and construction phases as necessary.



Studio

Apartment 06

Level

Typical Floor (2+)

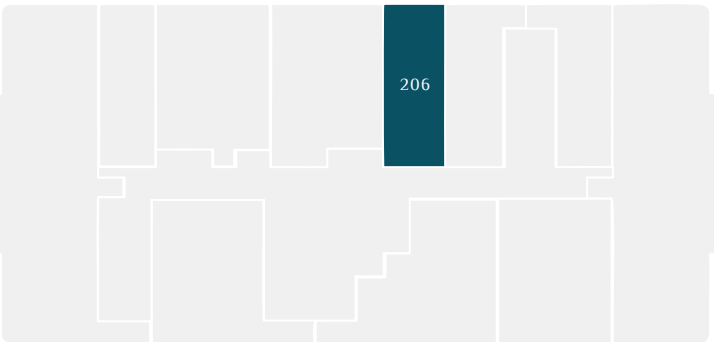

|            |              |
|------------|--------------|
| Suite :    | 335.7 sqft   |
| Balcony :  | 55.4 sqft    |
| Total Area | : 391.2 sqft |

Disclaimer: All floor plans, layouts, dimensions, and specifications shown are for illustrative purposes only and are subject to change at the discretion of HRE Development without prior notice. The developer reserves the right to make modifications during the design and construction phases as necessary.





1-BED

Apartment 07

Level  
Typical Floor (2+)

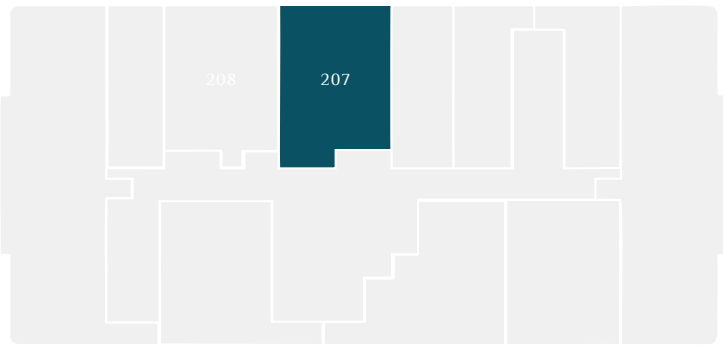

|              |                   |
|--------------|-------------------|
| Suite :      | 602.1 sqft        |
| Balcony :    | 104.9 sqft        |
| Total Area : | <b>707.1 sqft</b> |

Disclaimer: All floor plans, layouts, dimensions, and specifications shown are for illustrative purposes only and are subject to change at the discretion of HRE Development without prior notice. The developer reserves the right to make modifications during the design and construction phases as necessary.

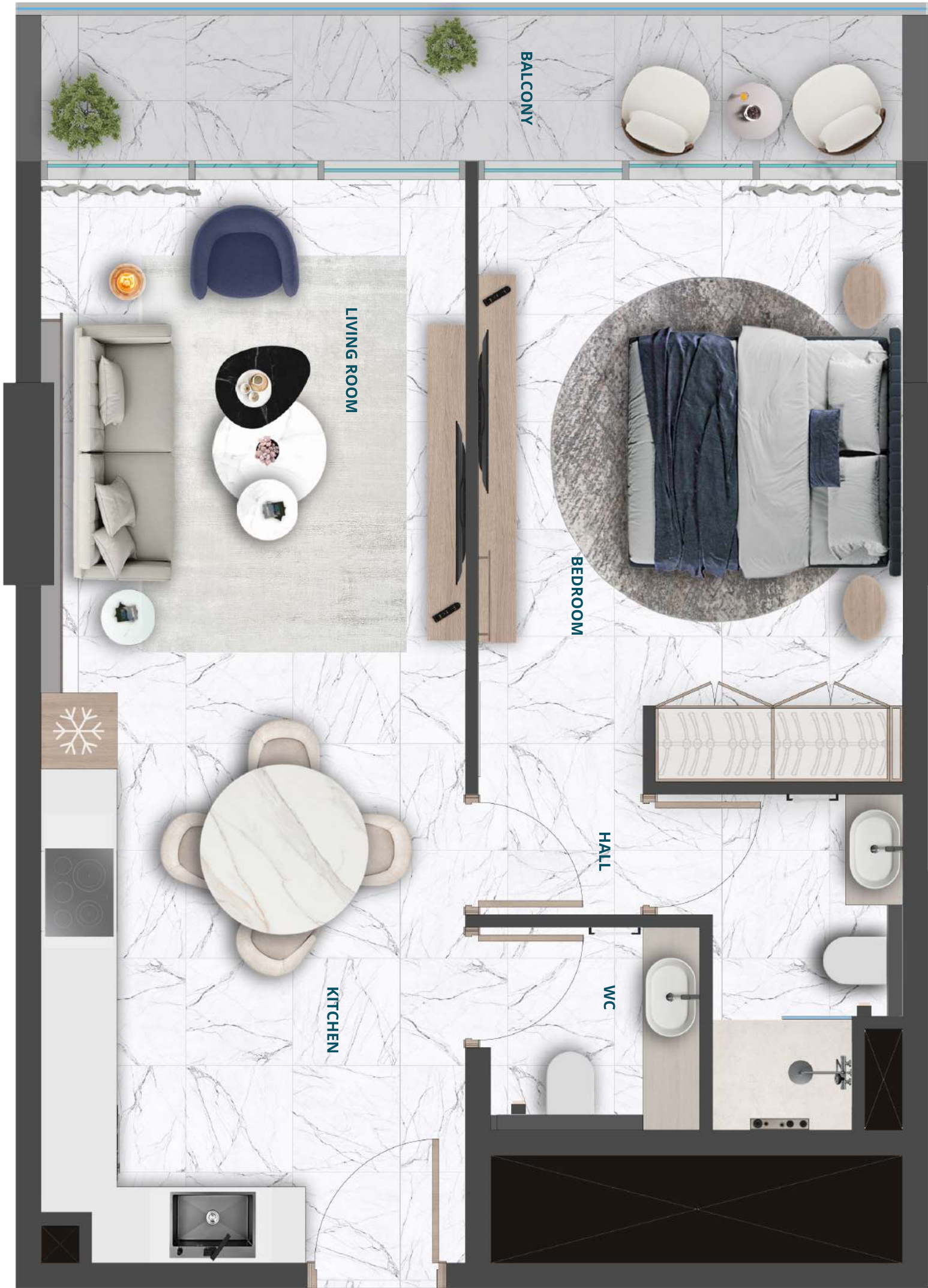



1-BED

Apartment 08

Level  
Typical Floor (2+)

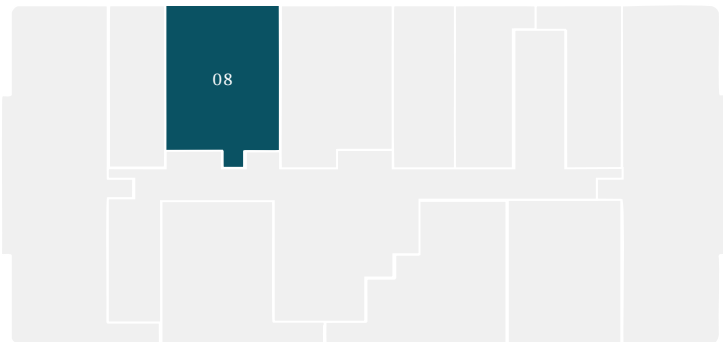

Suite : 577.9 sqft

Balcony : 104.8 sqft

Total Area : 682.8 sqft

Disclaimer: All floor plans, layouts, dimensions, and specifications shown are for illustrative purposes only and are subject to change at the discretion of HRE Development without prior notice. The developer reserves the right to make modifications during the design and construction phases as necessary.

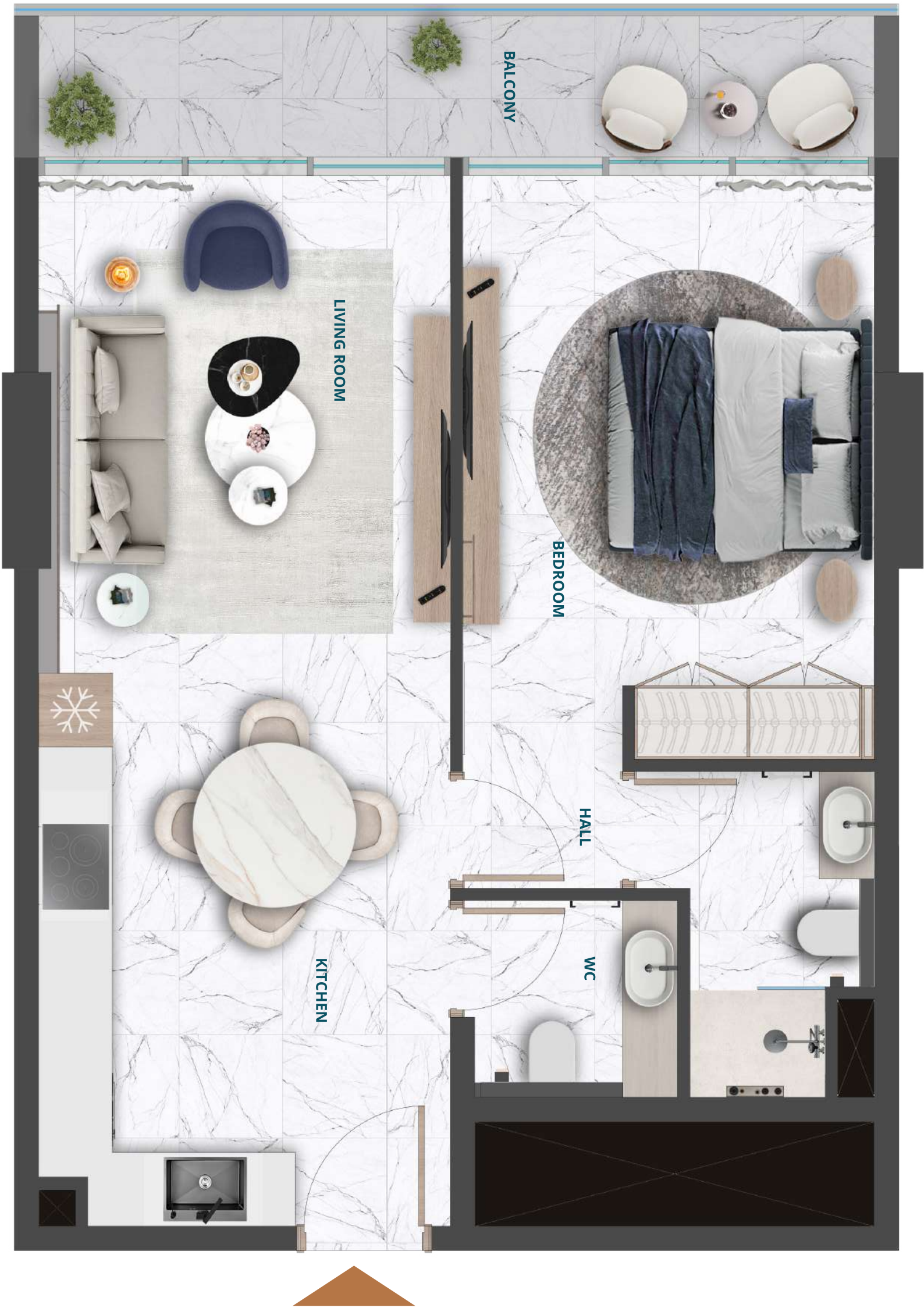



Studio

Apartment 09

Level

Typical Floor (2+)

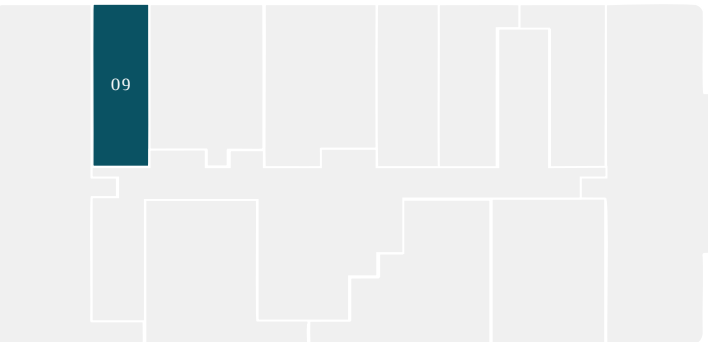

|              |            |
|--------------|------------|
| Suite :      | 316.8 sqft |
| Balcony :    | 52.4 sqft  |
| Total Area : | 369.2 sqft |

Disclaimer: All floor plans, layouts, dimensions, and specifications shown are for illustrative purposes only and are subject to change at the discretion of HRE Development without prior notice. The developer reserves the right to make modifications during the design and construction phases as necessary.

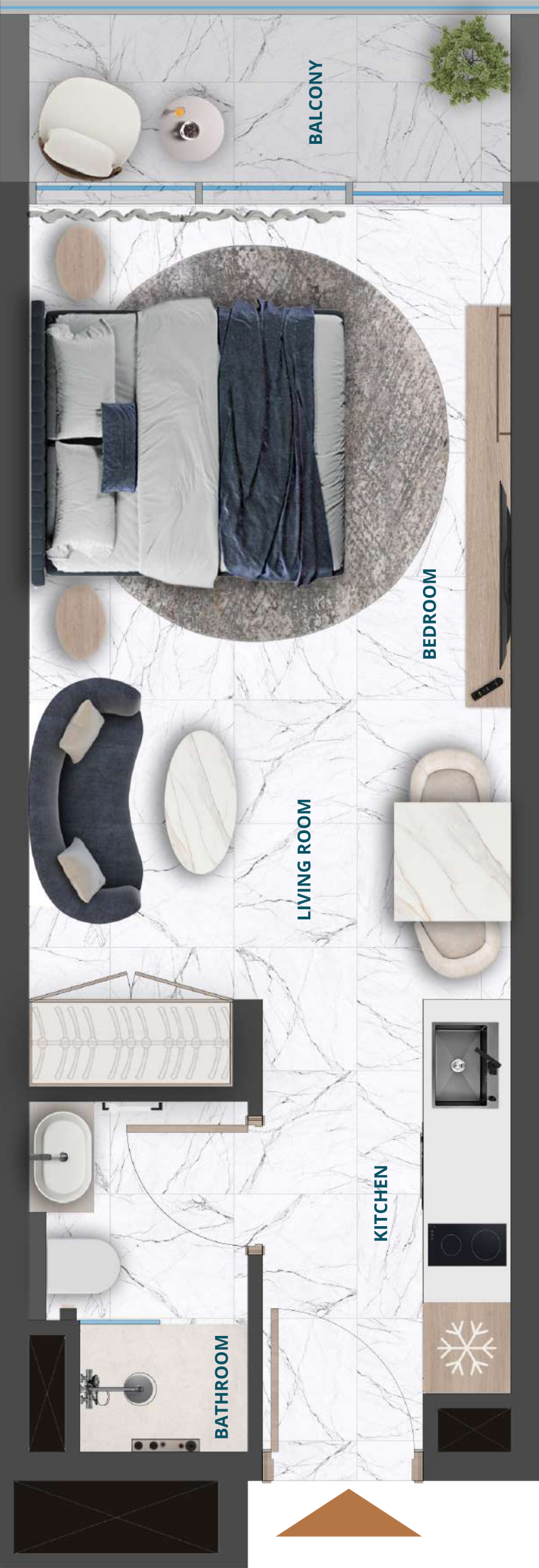

3-BED

Apartment 10

Level

Typical Floor (2+)

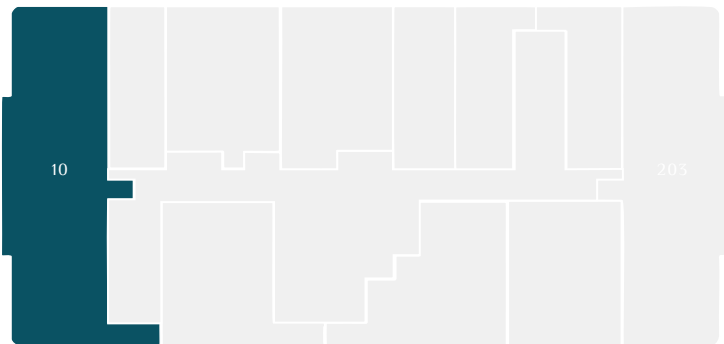

Suite : 1062.1 sqft

Balcony : 425.8 sqft

Total Area : 1,487.9 sqft

Disclaimer: All floor plans, layouts, dimensions, and specifications shown are for illustrative purposes only and are subject to change at the discretion of HRE Development without prior notice. The developer reserves the right to make modifications during the design and construction phases as necessary.





1-BED

Apartment 11

Level  
Typical Floor (2+)



- Suite : 567.7 sqft
- Balcony : 155.4 sqft
- Total Area : 723.1 sqft

Disclaimer: All floor plans, layouts, dimensions, and specifications shown are for illustrative purposes only and are subject to change at the discretion of HRE Development without prior notice. The developer reserves the right to make modifications during the design and construction phases as necessary.

